

Windows Computer **Wired** LG TV Display

This description is specific to the Calendar House LG television set-up and may not work with other systems.

1)Connect the TV HDMI cable to the computer.

2)Turn on both the TV and the laptop computer.

3)On the laptop, press and hold the **Windows Key** and then click the **P Key** on the keyboard and the following image should appear:

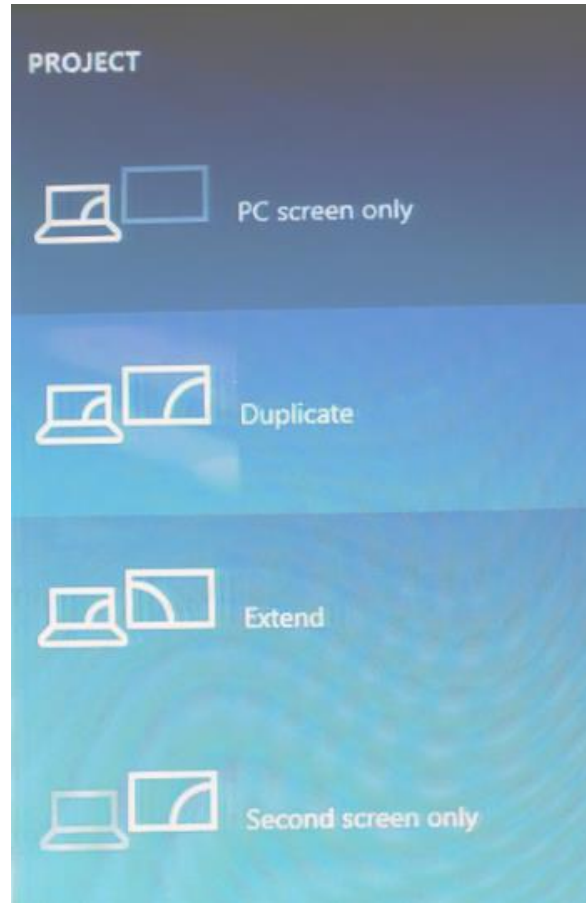

4)Click on “Duplicate” to select the option.

5) Use the LG TV remote and click the button at the top right. A list of connection options will appear on the TV. Use the LG remote arrow keys to scroll to the HDMI¹ option and then click the “**OK**” button. After a few seconds, the TV should copy the laptop screen and you may start your presentation.

